

TECHNICAL CHARACTERISTICS

MATERIAL
 INSULATOR: PA 6T
 FLAMMABILITY RATING: UL94-V0
 COLOR: BLACK
 CONTACT MATERIAL: COPPER ALLOY
 CONTACT TYPE: STAMPED
 CONTACT PLATING: GOLD
 QUALITY CLASS: 3 AS PER CECC 75 301-802
 PITCH: 2.54 MM

ENVIRONMENTAL
 OPERATING TEMPERATURE: -40 UP TO 125°C
 COMPLIANCE: LEAD FREE AND ROHS

ELECTRICAL
 CURRENT RATING: 3 A
 WORKING VOLTAGE: 250 VAC
 INSULATOR RESISTANCE: >1000 MOHM
 DIELECTRIC WITHSTANDING VOLTAGE: 500 VAC/MN
 CONTACT RESISTANCE: 20 mOHM MAX

STANDARD
 CERTIFIED: E323964

SOLDERING
 JEDEC LEAD FREE REFLOW SOLDERING

PACKAGING
 TAPE & REEL WITH CAP

DIMENSION
 A = 2.54 x (NB. PIN / 2 - 1)
 B = 2.54 x (NB. PIN / 2)
 CAP
 C = 4.8MM FOR 4 PIN
 C = 5.8MM FOR 6, 10, 14... PIN
 C = 8.3MM FOR 8, 12, 16, 20... PIN

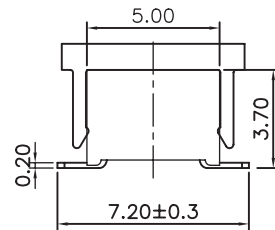
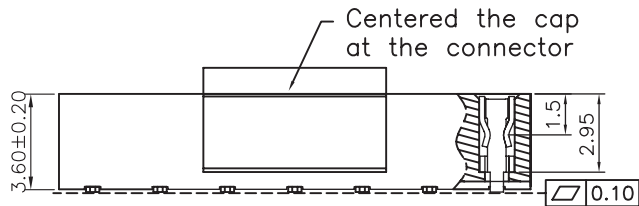
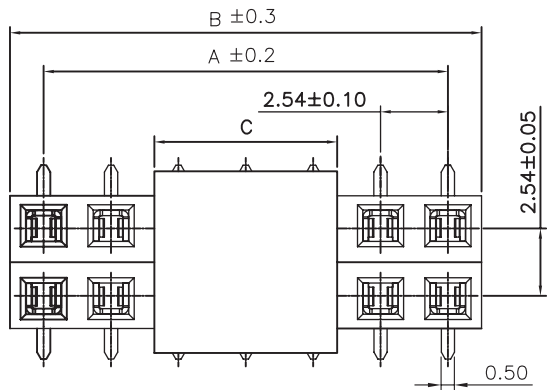

RoHS Compliant			
G			
F			
E			
D			
C			
B	29-MAR-17	DRAWING	AK
A	22-APR-09	PDF	JP
REV	DATE	FILE	BY

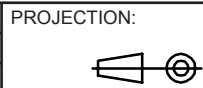

GENERAL TOLERANCE
 .X = +/- 0.2
 .XX = +/- 0.15



APPROVAL: GMo

UNIT: MM

DESCRIPTION: 2.54MM SMT DUAL SOCKET BOTTOM ENTRY

SIZE

SCALE:

WERI PART NO: 610 3xx 243 021

A4

SHEET: 1/3

DRAW: MIKE

A

B

C

D

1

2

3

4

5

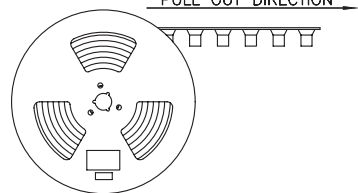
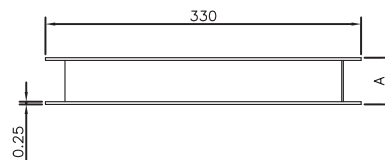
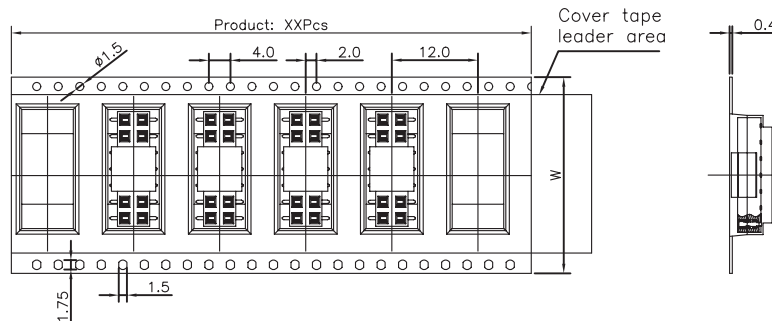
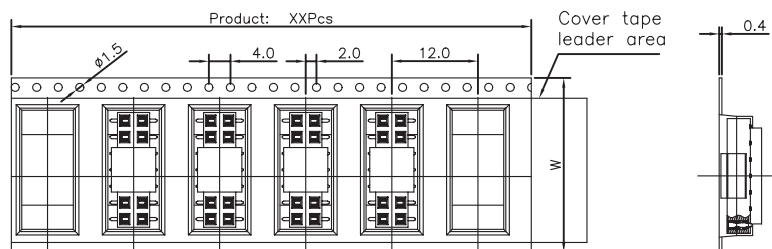
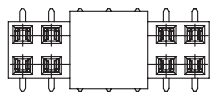

Note:

- 1.All dimensions meet EIA-481-3 requirements.
- 2.Material : Black Conductive Polystyrene Alloy
100% recyclable.
- 3.Thickness : 0.40±0.05mm
- 4.Component load per 13" reel :1000pcs.
- 5.Carton Size:350*350*296(mm)

Pin No	W	A	PCS/R	R/CTN	Q'TY	Pin No	W	A	PCS/R	R/CTN	Q'TY
04	16	21	1000	12	12*1000	26	44	49	1000	5	5*1000
06	16	21	1000	12	12*1000	28	56	61	1000	4	4*1000
08	24	29	1000	9	9*1000	30	56	61	1000	4	4*1000
10	24	29	1000	9	9*1000	32	56	61	1000	4	4*1000
12	32	37	1000	7	7*1000	34	56	61	1000	4	4*1000
14	32	37	1000	7	7*1000	36	56	61	1000	4	4*1000
16	44	49	1000	5	5*1000	38	72	77	1000	3	3*1000
18	44	49	1000	5	5*1000	40	72	77	1000	3	3*1000
20	44	49	1000	5	5*1000						
22	44	49	1000	5	5*1000						
24	44	49	1000	5	5*1000						

RoHS Compliant

PROJECTION:



APPROVAL: GMo

GENERAL TOLERANCE

.X = +/- 0.2

.XX = +/- 0.15



DESCRIPTION: 2.54MM SMT DUAL SOCKET BOTTOM ENTRY

SIZE

A4

UNIT: MM

SCALE:

SHEET: 2/3

DRAW: MIKE

WERI PART NO: 610 3xx 243 021

REV	DATE	FILE	BY
G			
F			
E			
D			
C			
B			
A			

1

2

3

4

5

Cautions and Warnings:

This electronic component is designed and developed with the intention for use in general electronics equipments.

Before incorporating the components into any equipments in the field such as aerospace, aviation, nuclear control, submarine, transportation, (automotive control, train control, ship control), transportation signal, disaster prevention, medical, public information network etc. where higher safety and reliability are especially required or if there is possibility of direct damage or injury to human body, Würth Elektronik must be asked for a written approval.

In addition, even electronic component in general electronic equipments, when used in electrical circuits that require high safety, reliability functions or performance, the sufficient reliability evaluation-check for the safety must be performed before by the user before usage.

A

B

C

RoHS Compliant

G				PROJECTION: 	GENERAL TOLERANCE .X = +/- 0.2 .XX = +/- 0.15		
F							
E							
D							
C				APPROVAL: JC	UNIT: MM	DESCRIPTION: DISCLAIMER	SIZE A4
B					SCALE:		
A	10-SEP-14	PDF	QL		SHEET: 3/3	WERI PART NO: DISCLAIMER	
REV	DATE	FILE	BY		DRAW: QL		

D