

PCB LAYOUT - COMPONENT VIEW

TECHNICAL CHARACTERISTICS
 MATERIAL
 INSULATOR: PA 46
 FLAMABILITY RATING: UL94-V0
 COLOR: IVORY
 CONTACT MATERIAL: COPPER ALLOY
 CONTACT TYPE: STAMPED
 CONTACT PLATING: TIN
 QUALITY CLASS: 25 MATING CYCLES
 PITCH: 1.25MM

ENVIRONMENTAL
 OPERATING TEMPERATURE: -40 UP TO 85°C
 COMPLIANCE: LEAD FREE AND ROHS

ELECTRICAL
 CURRENT RATING: 1A
 WORKING VOLTAGE: 125V AC
 INSULATOR RESISTANCE: >100 MOHM
 DIELECTRIC WITHSTANDING VOLTAGE: 250V AC/MN
 CONTACT RESISTANCE: 20 mOHM MAX

STANDARD
 CERTIFIED: E323964

SOLDERING
 JEDEC LEAD FREE WAVE SOLDERING PROCESS

PACKAGING
 TUBE

DIMENSION
 A = 1.25 x (NB PIN - 1)
 B = 1.25 x (NB PIN) + 1.75

G	10-JUN-15	MIN. TEMP.	AK	PROJECTION: 	GENERAL TOLERANCE .X = +/- 0.2 .XX = +/- 0.15	WÜRTH ELEKTRONIK	
F	06-AUG-13	CHARACTERISTIC	QL				
E	29-OCT-12	PIN	GG				
D	19-SEP-12	PIN	GG				
C	25-AUG-10	PACKAGING	JC				
B	18-FEB-09	DRAW	JP	APPROVAL: BBu	UNIT: MM	DESCRIPTION: 1.25 MM MALE HORIZONTAL SHROUDED HEADER	SIZE
A	07-NOV-08	PDF	JP		SCALE:	WERI PART NO: 653 0xx 117 322	A4
REV	DATE	FILE	BY		SHEET: 1/3		
					DRAW: MIKE		

1

2

3

4

5

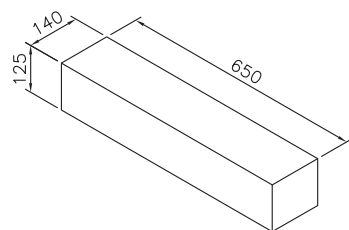
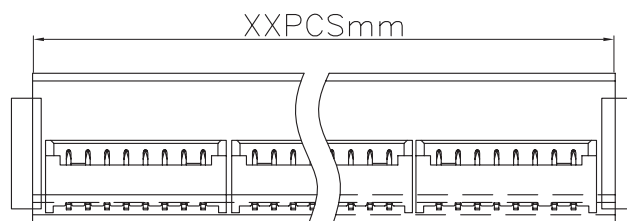
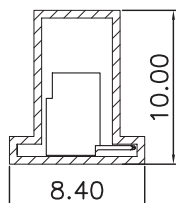
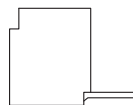
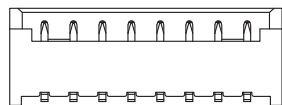
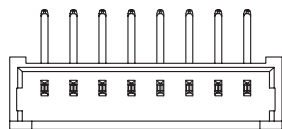

INNER CARTON

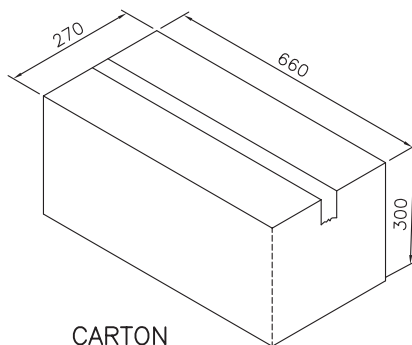

CARTON

Note:

1.Dimension

Tube Size:635(L) (mm)

Inner Carton Size:650(L)X140(W)X125(H) (mm)

Carton Size:660(L)X270(W)X300(H) (mm)

2.Quantity:

XX Pcs/Tube

120 Tube/Inner Carton

4 Inner Carton/Carton

Pin.	Pcs/Tube	Pcs/Inner Carton	Q'TY/Carton
2	142	17040	68160
3	109	13080	52320
4	89	10680	42720
5	75	9000	36000
6	65	7800	31200
7	57	6840	27360
8	51	6120	24480
9	46	5520	22080
10	42	5040	20160
11	39	4680	18720
12	36	4320	17280
13	33	3960	15840
14	31	3720	14880
15	29	3480	13920

RoHS Compliant

PROJECTION:



GENERAL TOLERANCE

.X = +/- 0.2

.XX = +/- 0.15



APPROVAL: BBu

UNIT: MM

DESCRIPTION: 1.25 MALE HORIZONTAL SHROUDED HEADER

SIZE

SCALE:

A4

SHEET: 2/3

WERI PART NO: 653 0xx 117 322

DRAW: PEARL

REV	DATE	FILE	BY

1

2

3

4

5

Cautions and Warnings:

This electronic component is designed and developed with the intention for use in general electronics equipments.

Before incorporating the components into any equipments in the field such as aerospace, aviation, nuclear control, submarine, transportation, (automotive control, train control, ship control), transportation signal, disaster prevention, medical, public information network etc. where higher safety and reliability are especially required or if there is possibility of direct damage or injury to human body, Würth Elektronik must be asked for a written approval.

In addition, even electronic component in general electronic equipments, when used in electrical circuits that require high safety, reliability functions or performance, the sufficient reliability evaluation-check for the safety must be performed before by the user before usage.

A

B

C

RoHS Compliant

G				PROJECTION: 	GENERAL TOLERANCE .X = +/- 0.2 .XX = +/- 0.15		
F							
E							
D							
C				APPROVAL: JC	UNIT: MM	DESCRIPTION: DISCLAIMER	SIZE A4
B					SCALE:		
A	10-SEP-14	PDF	QL		SHEET: 3/3	WERI PART NO: DISCLAIMER	
REV	DATE	FILE	BY		DRAW: QL		

D