

CUSTOMER TERMINAL	RoHS	LEAD(Pb)-FREE
Sn96%, Ag4%	Yes	Yes

more than you expect

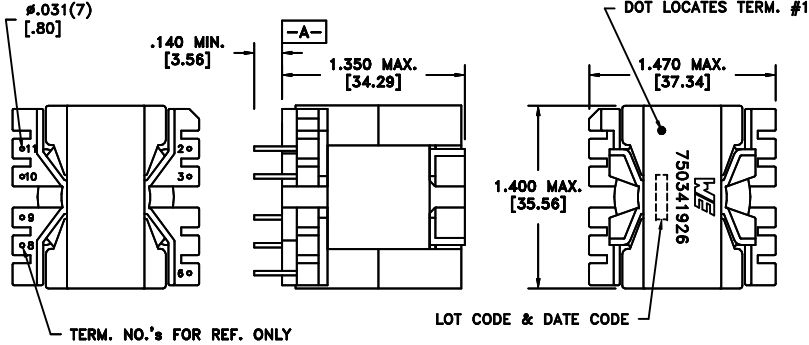

PART MUST INSERT FULLY TO SURFACE A IN RECOMMENDED GRID



ELECTRICAL SPECIFICATIONS @ 25°C unless otherwise noted:

PARAMETER	TEST CONDITIONS	VALUE
D.C. RESISTANCE	8-11 @20°C(Tie 8+9,10+11)	0.055 ohms Max
D.C. RESISTANCE	2-3 @20°C	0.194 ohms ±10%
INDUCTANCE	8-11 10kHz, 1.0VAC, Ls(Tie 8+9,10+11)	76.0uH ±10%
DIELECTRIC	(Tie 8+9,10+11), 800VAC, 1 second	---
TURNS RATIO	(8-11):(2-3) (Tie 8+9,10+11)	9.33:1, ±2%

GENERAL SPECIFICATIONS:

OPERATING TEMPERATURE RANGE: -40°C to +125°C including temp. rise.

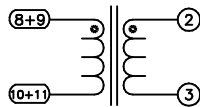

NOTES: Customer to tie terminals #8+9,10+11 on PCB board.

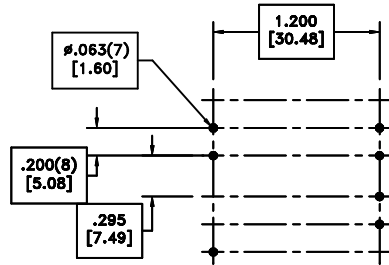

RECOMMENDED P.C. PATTERN, COMPONENT SIDE

Wire insulation & RoHS status not affected by wire color.
Wire insulation color may vary depending on availability.

REV.	DATE	Packaging Specifications Method: Tray PKG-0825 www.we-online.com/midcom		Tolerances unless otherwise specified: Angles: ±1° Fractions: ±1/64 Decimals: ±.005 [.13] Footprint: ±.001 [.03]	DRAWING TITLE INDUCTOR PFC	PART NO. 750341926
00	06/13	SEE REVISION SHEET FOR REVISION LEVEL	CONVENTION PLACEMENT REVISION LEVEL	This drawing is dual dimensioned. Dimensions in brackets are in millimeters.	eiSos p/n: 750341926	compliant RoHS SPECIFICATION SHEET 1 OF 1